

Assembly instruction UNIVERSALIA

Step 1 - Place in position

Place in position UNIVERSALIA at the window profil

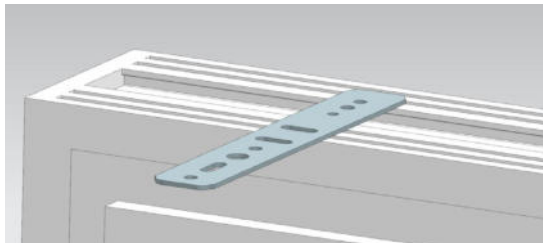

Step 2 - Screw on

Screw on with suitable window screw at the window profile

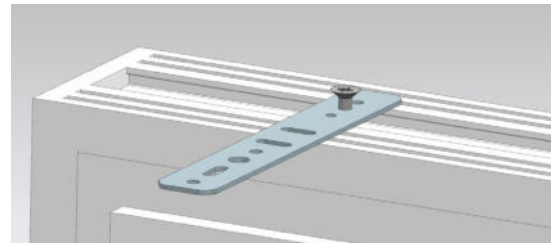

Step 3 - Bend

After screw on, the required offset high can be bent with target bending points (elongated holes)

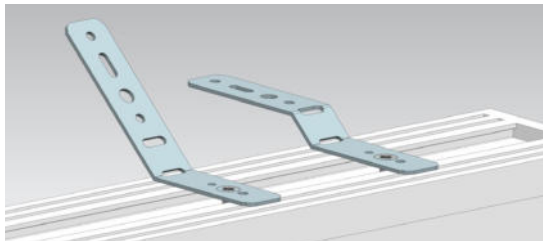

Step 4 - Insert window frame

Insert the window frame, align it and use suitable window screw to fix at the embrasure

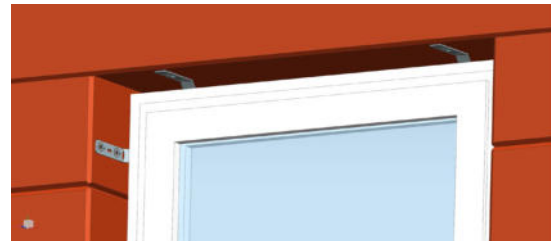

Note: The weight of the window must be absorbed by supporting and spacer blocks (not included in scope of delivery) on the underside of the window