

Assembly instruction THERMINATOR

Step 1 - Place in position

Place in position front part of THERMINATOR-claw at the window profil

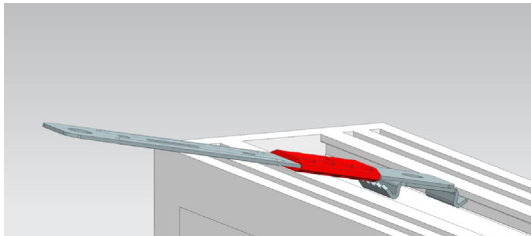

Step 2 - Knock in

Use a Hammer to knock in claw at the window profile

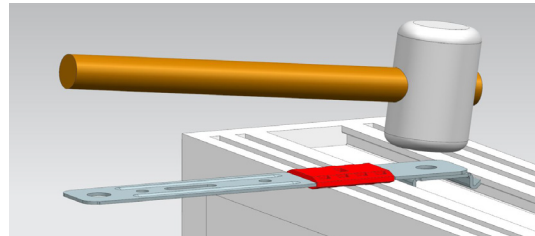

Step 3 - Bend

After knock in, the required offset high can be bent with target bending points (elongated holes)

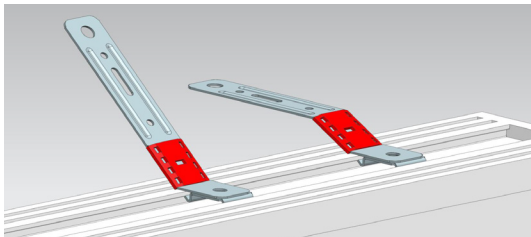

Step 4 - Insert window frame

Insert the window frame, align it and use suitable window screw to fix at the embrasure



Note: The number of THERMINATOR depends on the size of window - the distance between the THERMINATOR may be a maximum of 700 mm for PVC windows. The weight of the window must be absorbed by supporting and spacer blocks (not included in scope of delivery) on the underside of the window.