

Assembly instruction SARGO

Step 1 - Place in position

Place in position SARGO at the window profile

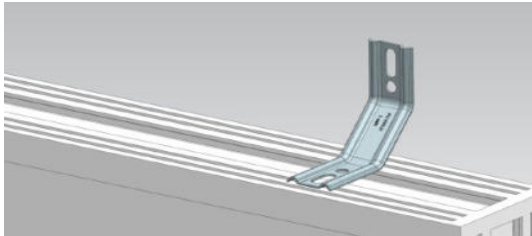

Step 2 - Align

Align at a 90° angle to the window profile

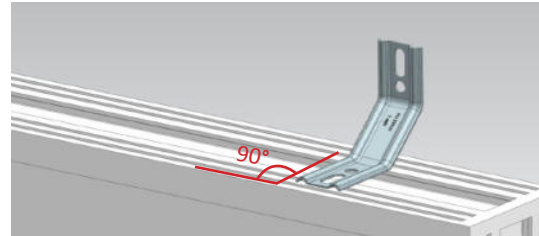

Step 3 - Screw on

Screw on SARGO, with suitable window screw at window profile

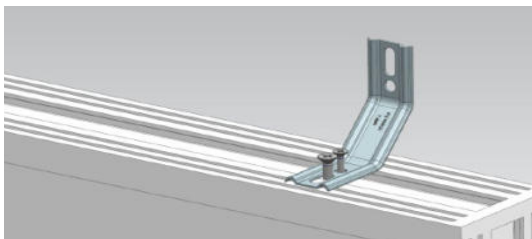

Step 4 - Insert window frame

Insert the window frame, align it and use suitable window screw to fix at the wall



Note: The weight of the window must be absorbed by appropriate structural measures / suitable brackets or similar (not included in the scope of delivery) on the underside of the window